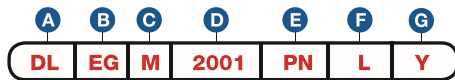

Item Number

To determine your item number enter the **RED** option code for each section as in the example below.

**A Lock Style**

DL Drawer/Door Lock

B Core Type

EG Electronic Medeco® XT

C Housing Length

M 1-1/4"

D Bolt Type**STRAIGHT BOLT**

2001 1-1/8"
2002 1-3/4"
2003 2-3/8"
2004 3-3/16"

3/8" OFFSET BOLT

2205 1-11/16"

DIECAST SPRING BOLT

3209 1-3/8" Std.

SLIDING SPRING BOLT

3410 1-3/8" Left
3411 1-3/8" Right

E Plating Finish

Extended lead-time and plating lot charges may apply to Special and Custom finishes.

Special Finish	{	PN Polished Nickel
		SN Satin Nickel
		PB Polished Brass
		SB Satin Brass
		BL Matte Black
		ST Statuary Bronze
		CF Custom Finish

F Handing

L Left
R Right
V Vertical
I Inverted

G Key Retaining

*Option available only on Spring Bolt models.

N* No
Y Yes

Note: Keys are not included with this lock. See page EG 9 to order keys.

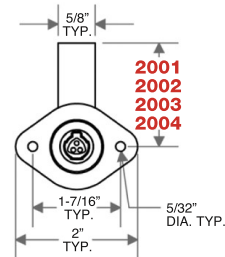
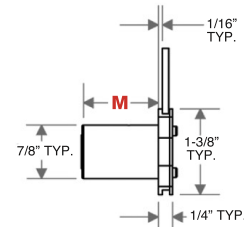
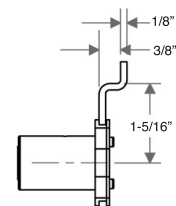
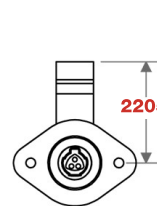
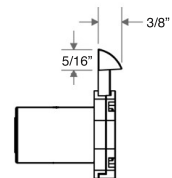
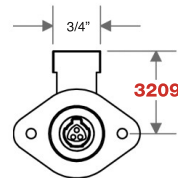
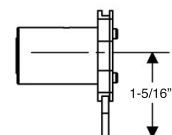
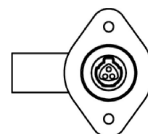

"Throw" (distance bolt travels from the locked to unlocked position) is 7/16". All dimensions shown are in the locked position.

D STRAIGHT BOLT VERTICAL**C HOUSING LENGTH****D 3/8" OFFSET BOLT VERTICAL****D DIECAST SPRING BOLT VERTICAL (3/16" bolt engagement recommended)****D SLIDING SPRING BOLT INVERTED****F RIGHT STRAIGHT BOLT****LEFT STRAIGHT BOLT**